

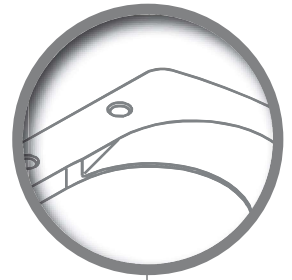

**LOCKING PIN**  
Enables a secure head closing.



# XCG85

## HYDRAULIC HEAD GUILLOTINE CABLES CUTTER

700 bar

> Force, stroke, capacities same as the manual tool **CG85** and battery tool **BCP085G**.

**TYPE OF CABLES**  
copper and aluminum

**MAX. PASSAGE**  
Ø 85 mm

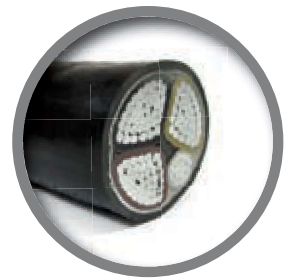

**NEW COUNTER BLADE**  
Decreases cable distortion when cutting.



**SHARP BLADE & COUNTER BLADE**  
Improve the cable cutting (> copper and aluminum cables).



**ERGONOMIC HANDLE**  
Easy to care and for a secured tool handling.

**FORCE**

55 kN

**DIMENSIONS** (L x l x h in mm)

395 x 80 x 170

**WEIGHT** (without protection kit)

6.200 kg



**PROTECTION KIT**  
> As an option.



**FITTINGS & HOSES**  
> Refer to **PAGE 67**.

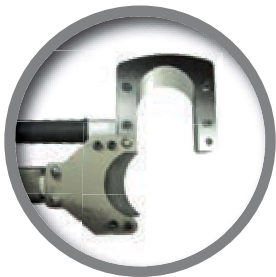

**WIDE OPENING**  
Easy for cables passage.

**MAX. CUTTING CAPACITIES**

TYPE OF CABLES	MAX. Ø OF CUT *
UNDERGROUND INSULATED ALUMINUM CABLES	3 x 240 mm <sup>2</sup> + 1 x 95 mm <sup>2</sup>
COPPER CABLES	1 x 630 mm <sup>2</sup> > 800 mm <sup>2</sup>
TELEPHONE CABLES	630 mm <sup>2</sup>
	Ø 85 mm

\* Other dimensions and cables to be tested and validated.



Do not use this tool on live cables.